

# Alternative modes of transport



Tasos Calantzis  
September 2005

# Alternative modes of transport

process

approach

suggestions

field trips  
+expert presentations



terrain



# observations

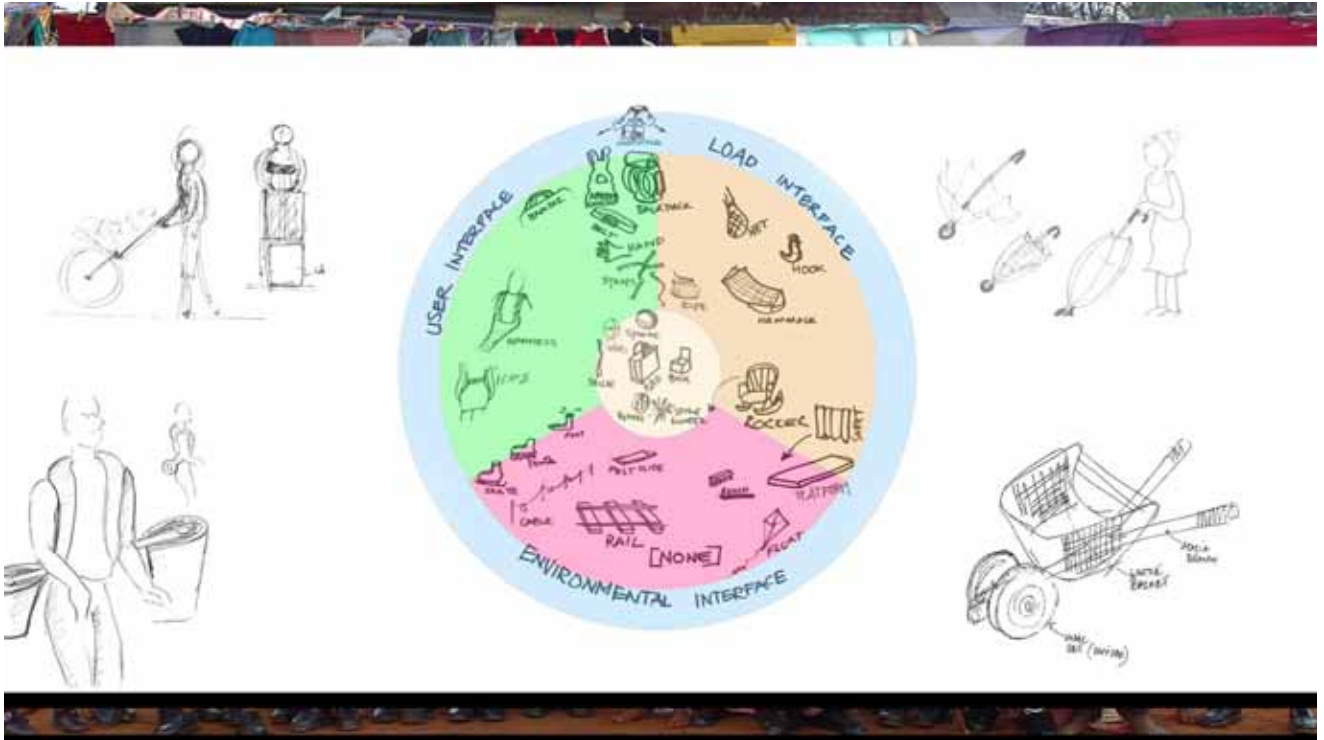

# interaction + feedback



making sense



making brief

- SHORT RANGE SINGLE-PERSON DEVICE
- \* BETTER OPTION TO EXISTING ALTS
  - \* SOME LOCAL MAT'L & MANUFACT'G (SPECIALIZED) (U.S.) (R.FIND) (SMB BUDGET)
  - \* EASIER TO LIFT ↑ BALANCE ↓ THE LOAD FLT
  - \* COST (< 100R) 75R 50R
  - \* EASY ADOPTION
  - \* EASY TO GET HOLD ⇒
  - \* INTRODUCES EDUCATION EXPERIENCE
  - \* DURABLE (CAN'T BREAK/ROTATE) RE-USE (IN PART) W/IDE
  - \* MANEUVERABLE
  - \* SMALLER VOLUME WHEN NOT IN USE (@ REST)
  - \* 1-hand use
- UBIQUITOUS "JOB" DOMESTIC
-

# domestic context



# raw materials

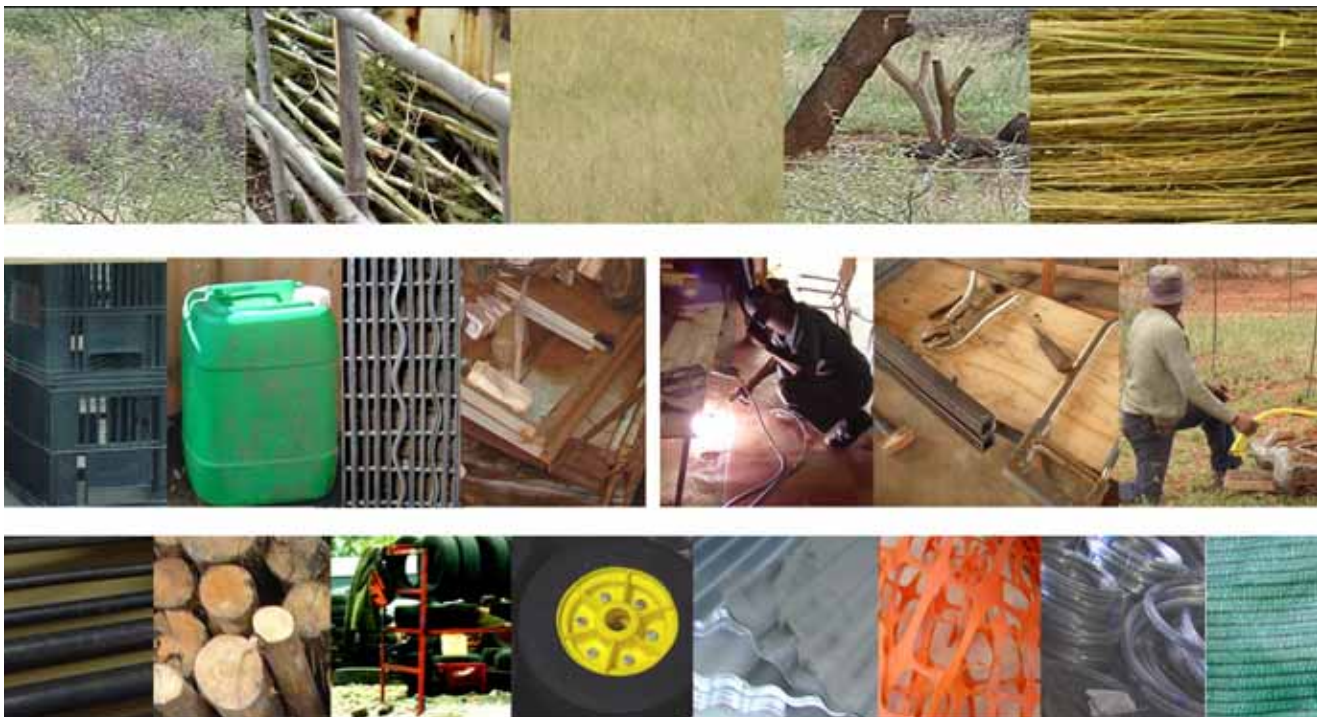

# ideas



## archetype +derivations

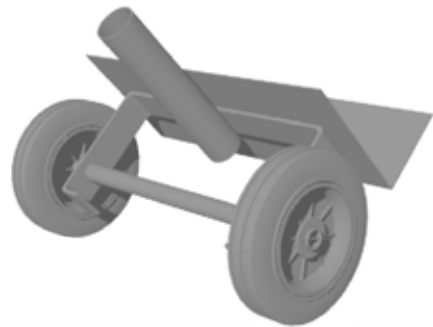

making



field testing...



# ;what next?

See if you can propose a **follow up workshop** or event consisting mainly of **South African design students**, and, if ambitions and funds permit include other students from **diverse disciplines (with a good induction plan)** to **work directly with rural folks** to build and refine some of the concepts that have been developed at the Interdesign 2005.

To make this work we will need to develop a **field dissemination kit** of sorts with graphic materials about the concepts shown in a "generic manner", re-drawn if necessary, so that **each local community can interpret** the concept based on their local resource and ability. This workshop in the field can then be documented and fed back to the community to **build confidence in themselves**.

The next step of implementation, is very possible and do-able with a **small budget**, but it needs **conviction in the process** and a lot of youthful energy to be mobilised at a **political and ideological** level besides mobilising knowledge and skills.

Prof. M.P. Ranjan

# ;what next?

"get some real entrepreneurial action started"

# suggestions: new terrain

“We get to see a very thin slice of life and the environment within a community and this thin slice is what we then use to inform our design process. “

multi disciplinary teams

research methodology

business visionaries

previous successes

